

The Prince Charles Hospital

Ceiling Hoist Journey

Antoinet Staneke
Quality Effectiveness Support Team
The Prince Charles Hospital

April 2014

The Prince Charles Hospital

- Located in Brisbane
- Known as a Cardiac Thoracic Hospital but now General Hospital
- 498 overnight beds
- TPCH recognised the obesity pandemic at a early stage
- Focus was to have appropriate sized rooms and ceiling hoist installed



Ceiling Hoists

- 37 Ceiling hoists including 3 Bariatric Traverse system
- 1 Traverse system with a 250kg SWL
- 2 Rooms with double straight tracks
- Mixture of portable motors and fixed motors
- Rooms with tracks and no motors
- First ceiling hoist was installed in 2003



First Redevelopment stage

- Planning started in 2004, finished in March 2007
- General Med ward
- Bariatric room was designed with ceiling hoist track
- It has a double straight track ceiling hoist installed
- Portable ceiling motors x 2 to lift up 400kg
- 2 Bariatric Rooms of this type
- 2 straight tracks in other rooms
- ICU had several curved tracks installed with portable motors



Second Redevelopment Stage

- A working group was established with clinicians input
- Different agenda's
- No other hospitals in our surroundings who had implemented Bariatric rooms
- Focus on ceiling hoist system
- Business case for funding
- Architectural challenges



Ceiling Hoist Considerations

- We wanted a traverse system with a track to go into the bathroom
- Minimize patient handling effort
- Investigated several brands of ceiling hoists
- Standardization
- Training
- Service

[illegible]

Third Redevelopment

- Was developed in a existing ward
- Completed in March 2010
- 3 bedroom can be converted to Bariatric room
- Working group was involved in layout room
- No change in ceiling hoist system



Layout of the room

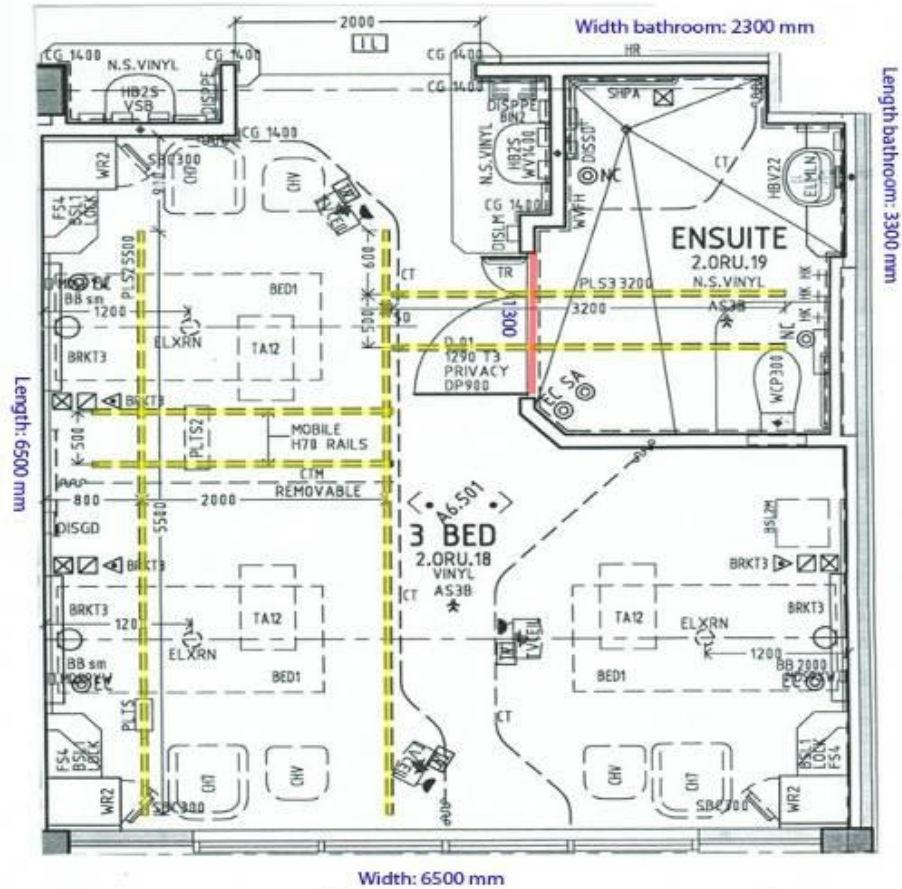

Latest Ceiling Hoist installation

- Completed in a existing Thoracic ward
- Close Observation Unit
- Space issues
- Choice to operate this unit with 1 bed less or install a ceiling hoist system



Thoracic Room design

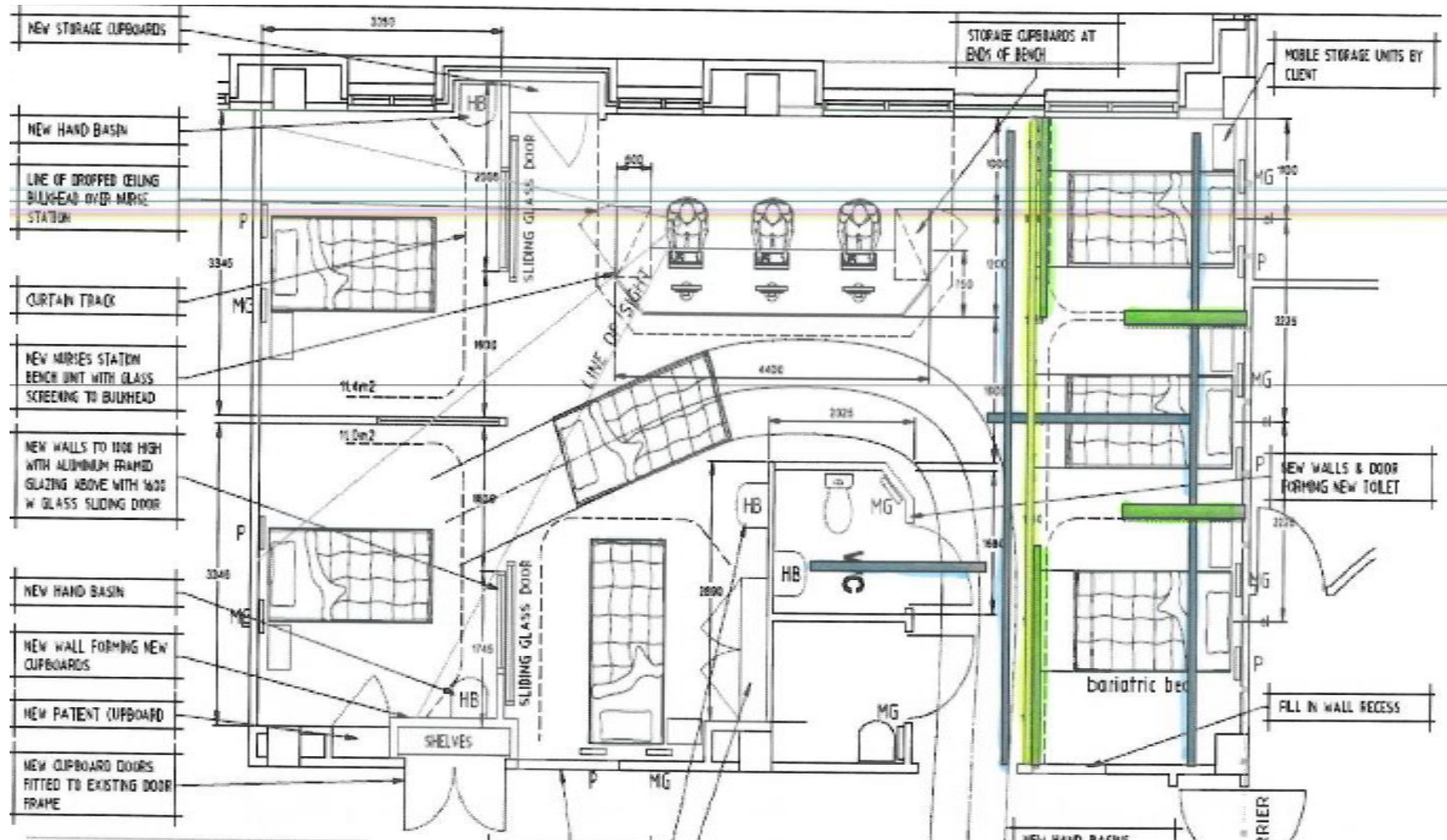

Ceiling Hoist Installation

- Ceiling hoists were installed by the company
- Issues with batteries and warranty



<http://www.liko.com>

Training

- Staff were trained prior opening the ward
- Company provided in house training
- Providing annual training on ceiling hoists
- Offer on the spot training



Maintenance

- Was difficult to get this off the ground
- Service contract of hoists was appointed to one provider. Competitor of the ceiling hoist
- Didn't service the hoists when they were still under warranty



Maintenance continue

- Planning is required when servicing the ceiling hoists
- Liaise with the wards/nursing staff
- Tracks need to be load tested and patient can not be in the room
- ICU is very difficult to get access to the tracks



Maintenance continue

- Tracks are not flush with the ceiling
- Dust collection on the tracks
- Dust collection on the straps if hoist have not been used
- Ensure the tracks and hoists are incorporated in a cleaning schedule
- If hoists are not been used ensure you run them up and down a couple of times each week to prolong battery life
- Handsets



Injury Reduction

- TPOCH collate incident data on Hoist and Sling incidents since 2010
- Only 2 reported incidents with ceiling hoist
- Caused by user error

Staff Injury

- No data available that is linked to the ceiling hoist installation
- There is a decline in Patient Handling injuries since 2010
- This can contribute to the Think Smart Patient Handling program which was implemented in 2010

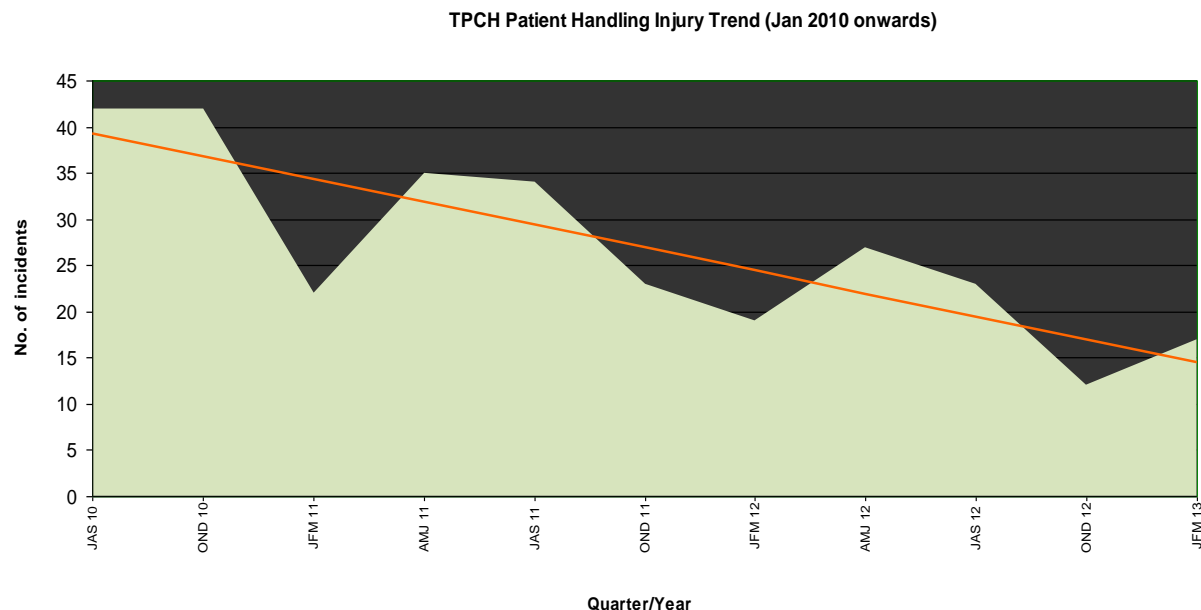

Clinical Benefits

- Staff love to use the ceiling hoists
- Easy to use
Easy to weigh patients
- Patients feel secure and safe
- We are a big fan of limb slings
multi straps
- Excellent for nursing procedures



Ceiling hoists beneficial enough in TPCH?

- Ward changes
- Ceiling hoists are not utilized enough.
- Ceiling hoists can be costly to maintain
- Looking installing tracks in other wards and moving the motors



Lessons Learnt

- Start a working group from the start have them involved in the whole process
- Portable motors do not work for us
- Ensure service contracts are sorted and that the ceiling hoists are serviced even in the warranty period.
- Install more traverse systems instead of straight tracks



Advice

- Try to install ceiling hoists in every ward have 2 or 3 rooms, at least 1 with a traverse system.
- Go for a system with a high SWL
- Look at your cliental do you need a bariatric system?
- Look at maintenance, servicing
- Allocate someone to organise the servicing
- Standardize, one brand
- Have a variety of slings available